

MULTISPLITTER SAW LONGITUDINAL CUT

MAINALI
LONG LIFE TECHNOLOGY

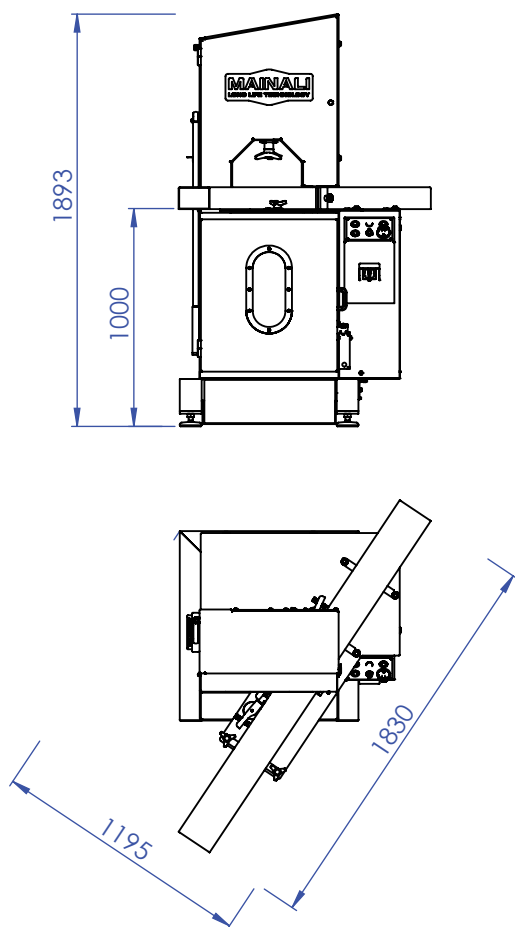

** Non-binding image, slight variations may occur.*

The MULTISPLITTER SAW with splitting conveyor has a special design with multiple saws that are working in parallel providing longitudinal cuts. It has been developed to make the cuts safely and quickly. It is a continuous cycle machine, compact and easy to use.

Depending on the type of product to be cut, the machine consists of lateral traction belts or a tunnel.

The MULTISPLITTER stands out for its safety and versatility, it can be customized according to the customer's needs.

The operator, who is not specialized, has to introduce the product into the intake tunnel and it comes out on the other side cut into multiple pieces, avoiding the risk of labor accidents.

The MULTISPLITTER SAW is capable of absorbing as many parts as an operator is able to feed into it, so the machine increases

ELECTRICAL POWER TUNNEL 11kW
ELECTRICAL POWER BELTS 11,5kW
WEIGHT 680Kg
VOLTAGE 380-490V III+PE o 220-240V III+PE
TOTAL DIMENSIONS 1830mm L / 1195mm W / 1893mm H

